

Single Family

7517 Lancaster Highway #5

Waxhaw, NC 28173

MOVE-IN READY



Home Priced At

\$655,000**Plan:** Charleston **3** Bedrooms **2.5** Bathrooms **2,706** Sq. Ft.

Welcome to The Charleston that combines spacious living with thoughtful functionality. Situated in the serene community of Waxhaw, residents enjoy a blend of small-town charm and modern conveniences. With a quaint downtown, and proximity to Charlotte, Waxhaw offers an ideal setting for families and professionals. Step into the home's foyer set between a dining room and a flex space, perfect for a home office or den. The heart of the home is a light-filled family room featuring a stunning wall of windows and seamless flow into the chef's gourmet kitchen, complete with an oversized island and open breakfast area. Retreat to the luxurious owner's suite offering a spa-inspired bath with a spacious shower, dual vanities, and a generous walk-in closet. Additional features include an arrival room at garage entrance with built-in drop zone for practical storage. Need more space? An additional unfinished space of 1004 sq ft to be used for storage or finish later and create your own vision.

First Floor

FIRST FLOOR



All square footage is approximate. Renderings are artist's conceptions and may vary slightly from the actual home. Homes may be built in reverse of plans shown, depending on site conditions. Minor architectural changes may be made occasionally at the option of the builder. Please contact your Sales Consultant for details.

Second Floor

OPT. SECOND FLOOR & REAR PORCH OPTIONS

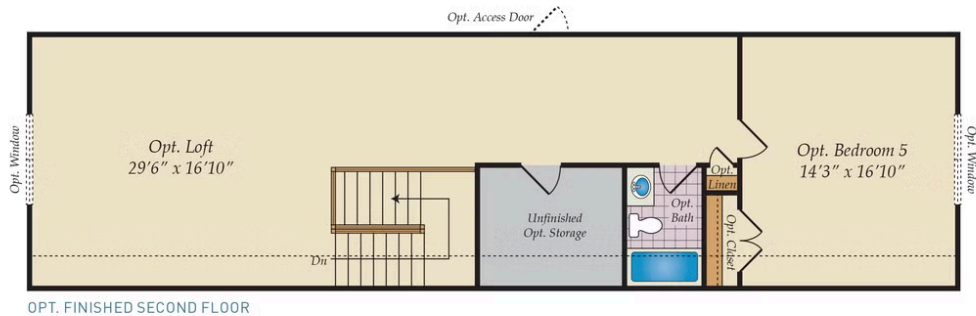

OPT. FINISHED SECOND FLOOR

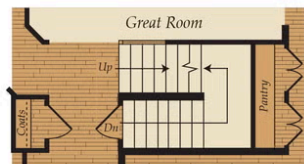

STAIRS W/ OPT. SECOND FLOOR & BASEMENT

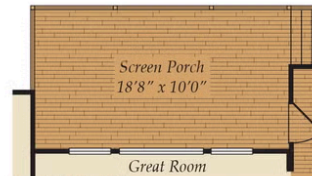

OPT. REAR DECK

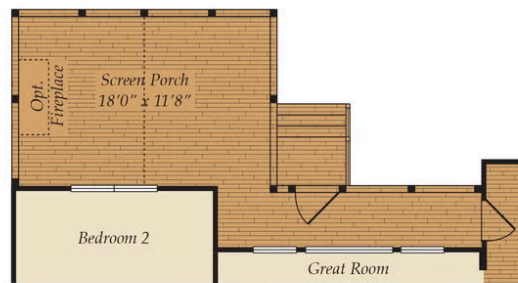

OPT. SCREEN PORCH

All square footage is approximate. Renderings are artist's conceptions and may vary slightly from the actual home. Homes may be built in reverse of plans shown, depending on site conditions. Minor architectural changes may be made occasionally at the option of the builder. Please contact your Sales Consultant for details.