

The Marais at Konterra

Laurel, MD 20707

**Call for Price**

-  **2-3** Bedrooms
-  **2-3** Bathrooms
-  **1,640-2,430** Sq. Ft.
-  **1 - 2** Car Garage

Right at Home, Right in the Heart of it All**Modern Garage Townhomes from the Mid-\$500s**

The Marais townhomes offer three distinct architectural styles with floor plans ranging from 2 to 5 bedrooms. Features like spa-inspired baths, rooftop terraces, and detached garages or private backyards bring quality and care to every detail. As Konterra's first residents, you'll have front-row access to what's taking shape here while staying connected to the whole region.

- **Modern garage townhomes** with an urban flair
- **Three spacious floor plans** designed for flexible living
- **Rooftop terraces and lofts** for elevated entertainment and relaxation
- **5-Piece Spa-inspired baths** offer a luxury experience more commonly found in custom homes
- **GE Induction Cooking Appliances** blend innovation and ease for everyday cooking
- **Green Fiber Core Walls** for superior sound reduction, insulation, temperature control, and fire safety
- **Park-like central square** for community gatherings and outdoor enjoyment
- **Miles of trails** connect the community to ponds and natural landscapes
- **Convenient access** to Washington D.C., Baltimore, Annapolis, and Rockville

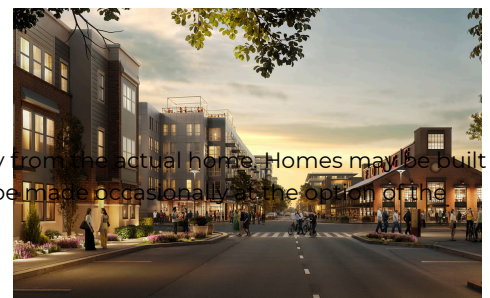
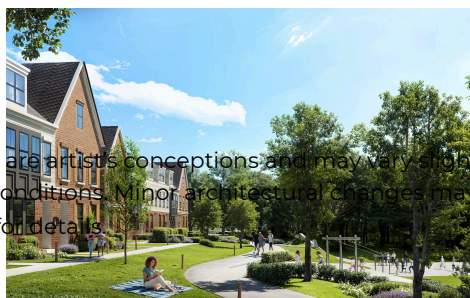
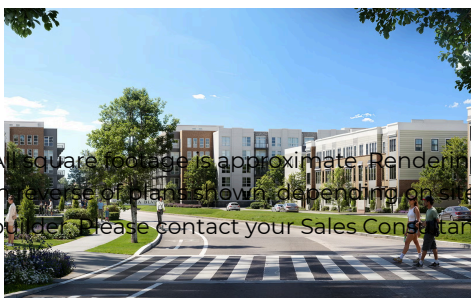

All square footage is approximate. Renderings are artist's conceptions and may vary slightly from the actual home. Homes may be built in reverse of plans shown, depending on site conditions. Minor architectural changes may be made occasionally at the option of the builder. Please contact your Sales Consultant for details.